

ST PETERS CHURCH CAMP

Sawtell Beach Caravan Park

September 4 - 6, 2009

What a great idea for us to get together for a weekend at the coast to enjoy one another's company along with some fun and teaching.

VENUE

The camp will be held at Sawtell Beach Caravan Park (SBCP). This is located right on the beach at Sawtell, in well kept parkland. It is 15 minutes south of Coffs Harbour and just over two hours from Armidale.

Details:

Sawtell Beach Caravan Park
Lyons Road, Sawtell NSW 2452
Tel: 1800 729 835
Email: info@SawtellBeachCaravanPark.com.au
Web: www.SawtellBeachCaravanPark.com.au

You can find out more about the venue in the SBCP colour brochure, which may be available with this brochure, or at the SBCP website (www.SawtellBeachCaravanPark.com.au).

ACCOMMODATION

You will need to arrange your accommodation directly with SBCP or organise to stay with someone who has already done so. See the contact details for SBCP under *Venue* above.

When you contact SBCP please let them know that you are booking for the St Peters camp. It is also important that you talk with them about linen.

Cabins & Villas ¹	Per night ²	No booked	Sleeps ³
Ocean Villas	\$160.00	2	5
Beach Villas	\$124.00	4	5
Hibiscus Villas	\$110.00	4	4
Family Cabins	\$94.00	4	4/5
Ensuite Cabins	\$83.00	2	4/5
Studio Cabins	\$77.00	2	2
Cabins	\$67.00	4	6
Additional Person	\$8.00		

1. See floor plans at end of this brochure
2. Prices quoted are for two people. Each additional person is \$8.00 per night
3. You can extend this by one person, but you will need to bring something to sleep on

Camping and caravan sites are also available.

Key Dates

Book accommodation - asap
Register - by August 24
Camp dates - September 4 - 6

Venue: Sawtell Beach Caravan Park.
Ph: 1800 729 835
SawtellBeachCaravanPark.com.au

Speaker: Tim Johnson

Accommodation / Food: Cabins / camping – you book with venue. Self-catering.

Further Information:

Alan & Janelle Hardy – 6775 1755

www.stpetersarmidale.org.au/camp

See the SBCP website for details on options and pricing. You can also phone SBCP if you would like further information (see under *Venue* above).

FOOD & CATERING

The camp is self-catering, so you must make arrangements for your own meals.

All cabins have cooking facilities. There is also a camp kitchen and barbeques are available close by.

We are planning a barbeque meal together for Saturday evening. The idea is to bring your own meat and share salads & dessert. We will contact you after you register to see what you can contribute.

SPEAKER

Our speaker this year will be Tim Johnson, currently Families Minister at St Hilary's in Kew, Victoria. Tim previously ministered with Stephen Williams in Sydney. He has a teaching ministry marked by clarity, ease of listening and faithfulness to the text. Tim is married to Anna (previously from Armidale) and has a daughter, Abigail, all of whom will be joining us at Sawtell.

PROGRAM

FRIDAY	
8.00pm	Intro session, singing and prayer
SATURDAY	
9.15am	Teaching session
10.30am	Morning tea
11.00am	Teaching session
12.15 – 4.00	FREE TIME
4.00pm	Teaching session
6.00pm	Shared BBQ dinner
7.30pm	Event / fun
SUNDAY	
10.00am	Teaching / Communion
12.00pm	Close

HOW TO GET THERE



REGISTRATION

The registration fees for the camp are \$12 for singles or \$30 for families. This is in addition to your accommodation, food and other costs.

The registration deadline is August 24.

If you'd like to come then you need to do the following:

1. Arrange your accommodation. Contact SBCP (details under *Venue* section above) to make a booking or make arrangements to bunk in with someone who has already booked.
2. Complete the registration form and submit it with the registration fee (\$12 for singles; \$30 for families) to the Parish Office.

Registration Form

Tear this form off, complete it and submit it with your payment to the Parish Office by August 24.

Type: Family (\$30) Single (\$12)

Names:

Phone: Mobile no:

Email:

Floorplans



Cabin
(7m x 3.3m)

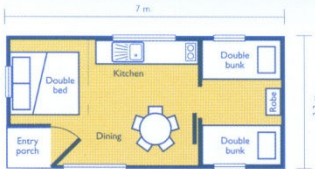

Studio Cabin
(7m x 3.3m)

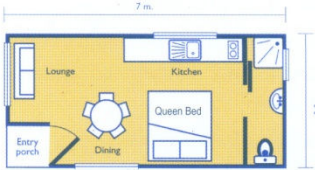

Ensuite Cabin
with veranda or carport
(7m x 3.3m)

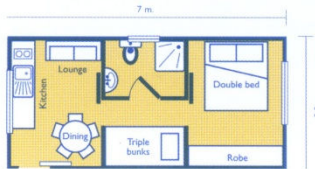

Family Cabin
with veranda or carport
(8m x 6.7m)



Ocean Villa
(12m x 5.3m)

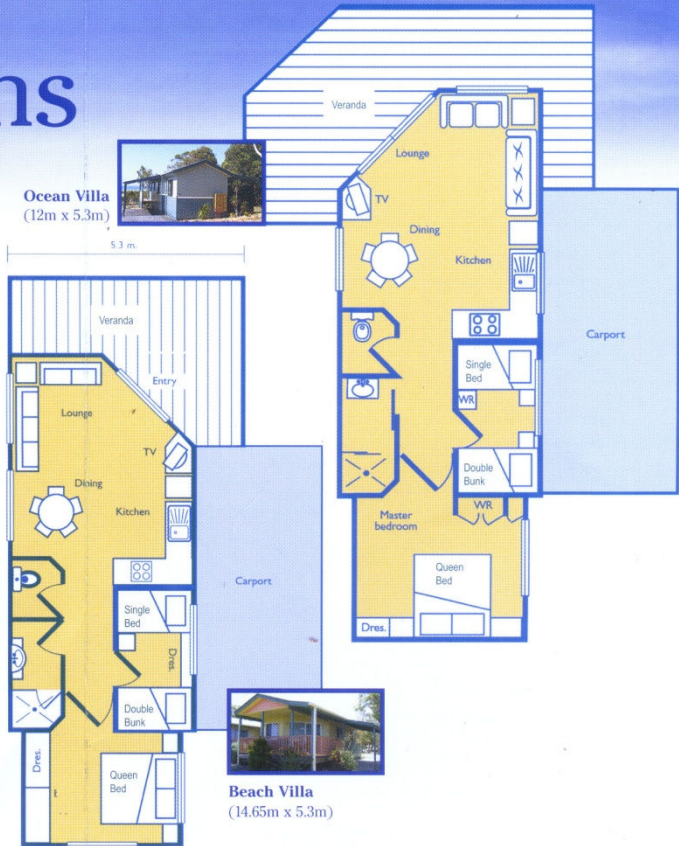

Beach Villa
(14.65m x 5.3m)

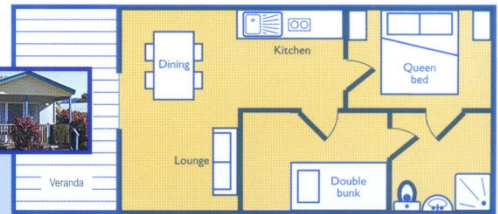

Hibiscus Villa (10m x 4.3m)

Floor plans and photos serve as a guide only, actual configurations may vary slightly.